

QUANTUM MPX™ TRUNK & JUMPER ASSEMBLIES



As part of the Quantum MPX™ Backplane Connectivity System, Stratos Lightwave offers a variety of pre-terminated and optically tested Trunk and Jumper Assemblies. The Quantum MPX™ Trunk and Jumper Assemblies are designed to bridge the high density interconnection between optical backplanes that serve as the input/output to other daughter cards, shelves or rack units. The MPX is an ultra-compact, multi-fiber array connector which holds up to 24 fibers, SM or MM utilizing a single thermoplastic ferrule. Stratos Lightwave manufactures all Quantum MPX™ cable assemblies to meet industry requirements and specifications.

Benefits

- High density backplane cabling
- Easy upgrading to higher fiber counts
- Reliable interconnection
- Eliminates space constraints
- AMP LIGHTRAY MPX® System compatibility

Features

- 1-24 fibers
- Singlemode or Multimode (50/125, 62.5/125)
- SC style push/pull latching mechanism
- Utilizes proven MT ferrule technology

Applications

- Optical Backplane
- Parallel Processing
- Optical Switches
- Optical Cross Connects
- Optical Circuits

Materials

- **MPX Grip Housing:** Thermoplastic (VO rated)
- **MPX Ferrule:** Reinforced thermoplastic
- **Strain Relief Boot:** Thermoplastic rubber (VO rated)
- **Crimp Sleeve:** Copper, tin plated
- **Fiber:** 9/125, 50/125, 62.5/125

Performance

	Singlemode (8° APC)	Multimode
• Insertion Loss		
Standard Models, Typical	0.35dB	0.35dB
Standard Models, Max.	1.0dB	1.0dB
Low-Loss Models, Typical	0.25dB	—
Low-Loss Models, Max.	0.5dB	—
• Return Loss, Min.	45dB	—
• Durability, ≤ 0.3dB Change	500 mating cycles	
• Vibration, ≤ 0.3dB Change	10 to 55 Hz	
• Temperature, Storage	-40°C to +85°C	
• Temperature Cycling, ≤ 0.3dB Change	-40°C to +80°C	
• Thermal Aging, ≤ 0.3dB Change	14 days @ +85°C	
• Humidity, ≤ 0.3dB Change	95% Rh @ +60°C	

Quantum MPX is compatible with AMP/TYCO Lightray MPX product under license by TYCO Electronics Corporation



Innovation Brought To Light

QUANTUM MPX™ TRUNK & JUMPER ASSEMBLIES

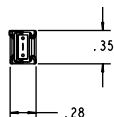
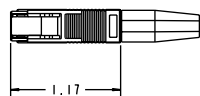
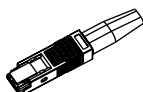

STRAIGHT BOOT

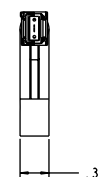
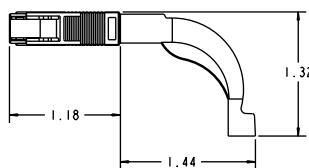

90° BOOT

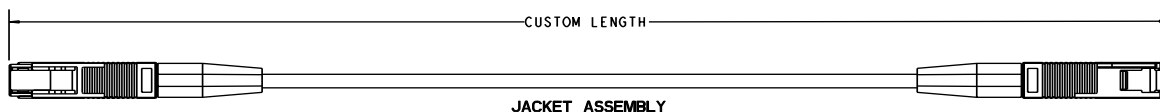

JACKET ASSEMBLY

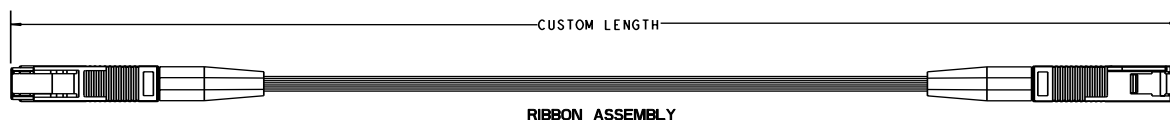

RIBBON ASSEMBLY

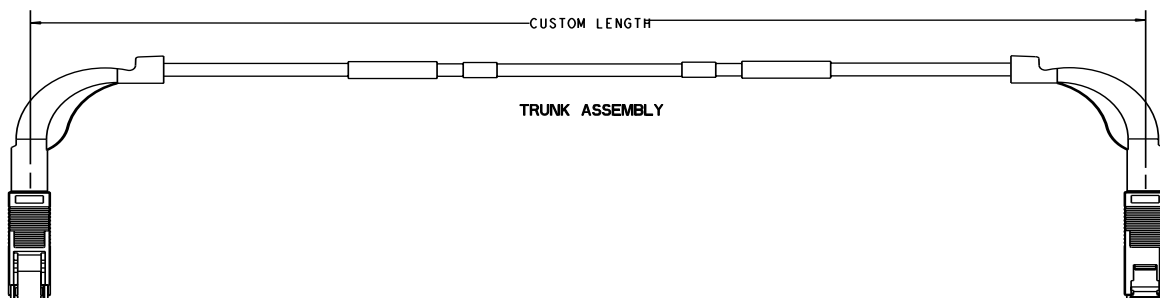

TRUNK ASSEMBLY

Company Contact Information

North America

7444 W. Wilson Avenue
 Chicago, IL 60706
 (708) 867-9600 Fax:(708) 867-9621
 (800) 323-6858
 www.stratoslightwave.com

Europe

Hollands Road Industrial Estate
 Haverhill, Suffolk CB9 8PR
 United Kingdom
 +44 (0) 1440 706441
 Fax: +44 (0) 1440 762044



Innovation Brought To Light